

## USER INSTRUCTION

By using the handle located at the inside of the arm or between seats - the footrest can be unfolded and the back can be regulated into rest positions.

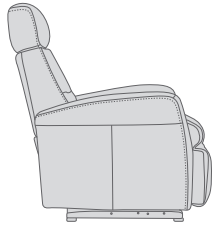

### FOLDED FOOTREST (IN)

- The back is locked in upright position
- Neck can be adjusted

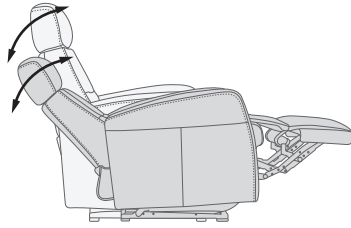

### UNFOLDED FOOTREST (OUT)

- The back angle can be adjusted from upright to rest positions
- The neck and head support can be adjusted

The built-in footrest can be unfolded by pushing the handle up placed inside of the arm or between seats. To fold in the footrest you should use your feet to press the footrest down towards the floor and move your bodyweight forward in the chair.

Do not use shoes directly against the footrest. This could cause damage to the cover/upholstery. Do not sit on the armrests. Never lift/carry the chair by the back or the footrest. Lift the chair by grabbing under the chairs arms or base. Two people are required to lift/carry the chair.

## MAINTENANCE

Bolts, screws and knobs can loosen after an extended period. This can create damage to the frame and instability to the furniture. Therefore, it is important to check and tighten all bolts, screws and knobs periodically. IMG recommends you to do this at least every four (4) months or as needed.

IMG Relaxers are equipped with an advanced mechanism that is made with many components, springs and moveable parts. Naturally, some sounds from the steel frame mechanism will occur. To avoid uncomfortable sounds you should tighten the screws regularly and use a few drops of oil or transparent grease on all screws and pivot points. Use penetration oil spray that is not too liquid to avoid leak/spill or transparent grease suitable for this type of application. Please ask your retailer for more information.

## SAFETY RULES



**PS!** Please be aware that improper use can cause injury.

- The back cover skirt(s) must always be properly fastened with Velcro tape to avoid hands/fingers accessing into the chairs mechanism from the rear.
- Adult supervision is required at all times when children are using the furniture, as moving mechanisms may be triggered causing serious injury.
- Mechanisms must only be triggered by the person sitting in the chair at the time.
- Keep hands and feet away from the mechanism(s).
- Always leave the chair(s) in upright position with folded in footrest.
- Do not sit on the armrest.
- Never sit on the footrest. Do not use the chair(s) or footrest(s) as step ladder.
- Use care when moving the product. Before lifting the chair secure the mechanism(s) to prevent unexpected opening or movement. Never move the chair by the mechanism, leg-rest, handle, back or base. Disconnect modular units before moving. Securely grip non-moving parts like arms or seat frame.
- Each chair can only be used by one person at a time.
- Armrest protection covers are recommended where supplied (for fabric cover).
- If parts are missing, broken, damaged or worn – cease use of the product until repairs are made, by a factory authorized parts only.
- Failure to follow these warnings could result in serious injury.

A  
S  
S  
E  
M  
B  
L  
Y  
I  
N  
S  
T  
R  
U  
C  
T  
I  
O  
N  
S

## CONGRATULATIONS

You are now the proud owner of a Modular Seating System by IMG. We are confident you will enjoy the comfort and style of this new furniture.

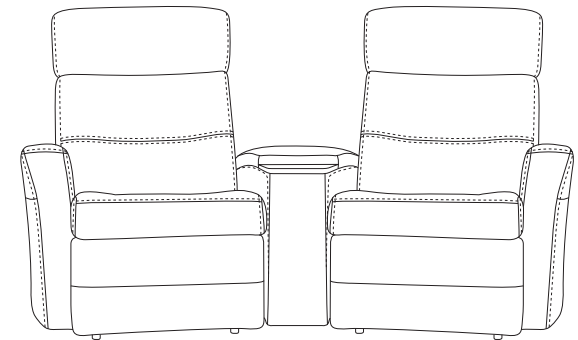

### IMPORTANT

Read this and other relevant instructions before using the product. Keep this manual for future reference.

**STEP BY STEP ASSEMBLY INSTRUCTIONS**

The units are delivered with the back and seat separated .  
The back is ready for assembly. Please proceed with the following steps:

**STEP 1**  
Remove any transportation safeguard arms (if any are attached).

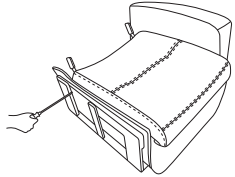

**STEP 2**  
Place the chair/unit on the floor.

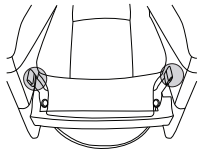

**STEP 3**  
Remove the connection protectors on the backs and the flanges/brackets protectors on the seats.



**STEP 4**  
Attach the backs by sliding the connectors into the flanges/brackets on the back part of the seat. Press the back down until you hear "click". Please ensure that you don't tear the skirt cover or that the skirt cover gets squeezed between the back and the seat.

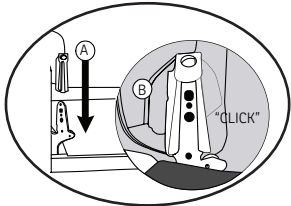
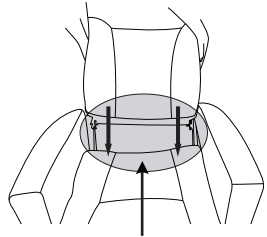

**STEP 5**  
Use the Velcro tape to fasten the skirt cover onto the lower part of the seat.

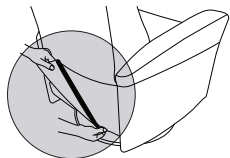

**ASSEMBLY OF SOFA UNIT**

Start the assembly with this unit, (from Left to Right).

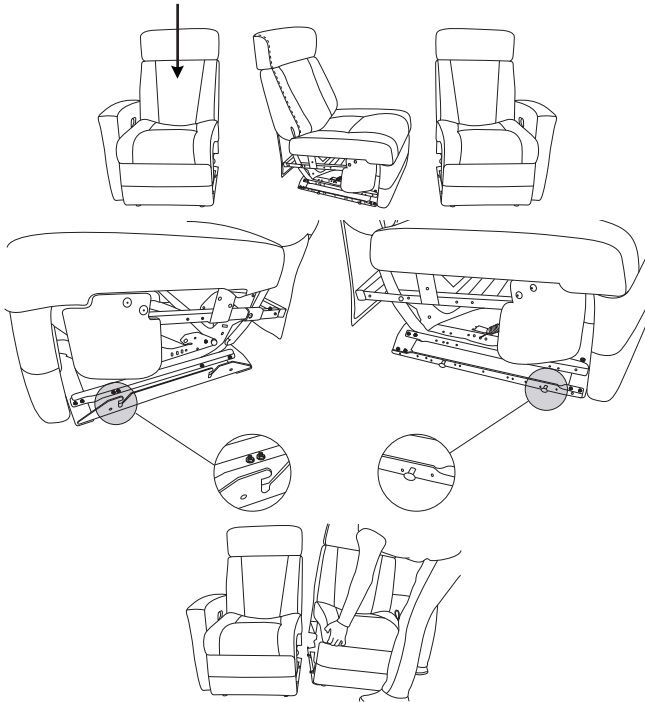

Connect more units on the same way

**ASSEMBLY OF CENTER ARM**

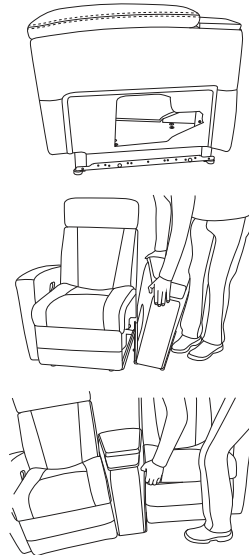

**DIFFERENT UNITS**

**DISASSEMBLY**  
If you need to disassemble the unit please start from right to left. Lift it up and pull forward to unconnect.

2-seats

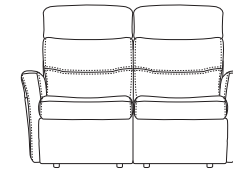

2-seats with center arm

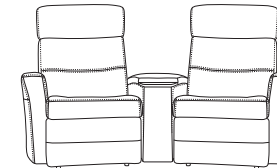

3-seats

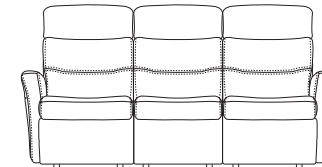

3-seats with center arm

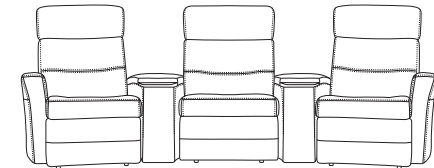

4-seats with center arm

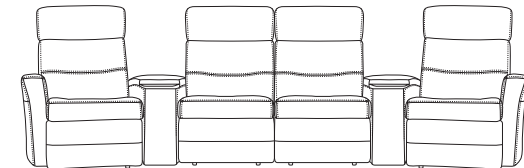

3-seats with 1 center arm

